



STANDARD FEATURES

- Inclined cold display pans
- Cold pans section
- Opening to accommodate crepe oven (not included)
- Stainless steel interior and exterior
- Stainless steel kickplate on operator side
- LED lighting on glasses
- Round or square cut out to lodge different crepe oven
- Built in socket and conduit plugs for crepe oven(s)

OPTIONS

- Heated pan section
- Stainless steel or transparent pans and lids
- Extra clear glasses
- Dip well (attached on exterior)
- Cold storage
- Stone work top
- Glass sneeze guard to match Oscartek display case
- Sides and front fascia in HPL or laminate
- Remote
- Casters

CREPE STATION

MODELS	LENGTHS	DEPTH	HEIGHT	# OF CREPE MAKER	WEIGHTS (LBS)	VOLTAGES	AMPS
CS1000	39 3/8" (1000mm)	37 5/8" (956mm)	40 11/16" (1033mm)	1	150	120/1/60	4
CS1500	59 1/16" (1500mm)	37 5/8" (956mm)	40 11/16" (1033mm)	2	190	120/1/60	6
CS2000	78 3/4" (2000mm)	37 5/8" (956mm)	40 11/16" (1033mm)	3	250	120/1/60	7
CS2400	94 1/2" (2400mm)	37 5/8" (956mm)	40 11/16" (1033mm)	4	(2) 190	(2) 120/1/60	(2) 6

CS SERIES FRONT COUNTERS

CREPE STATION

STANDARD SIDE VIEW

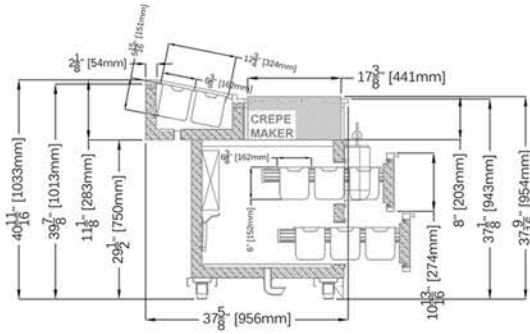

OPTIONAL: CURVED GLASS

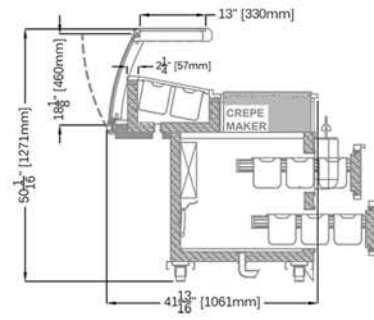

OPTIONAL: SQUARE GLASS

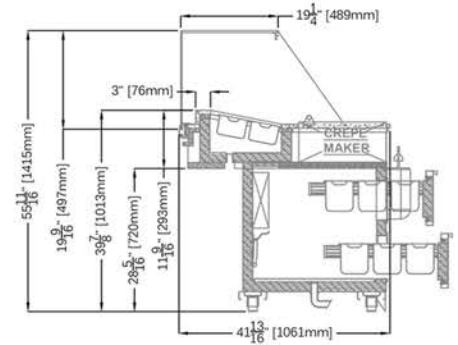
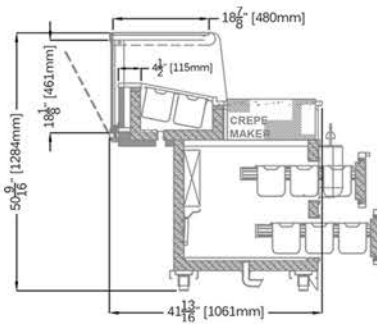
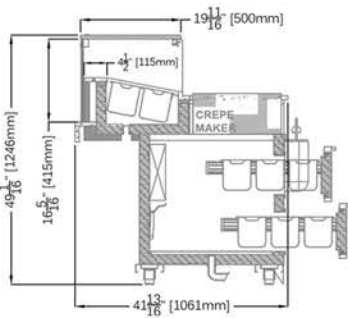

PLAN VIEWS

CS1000

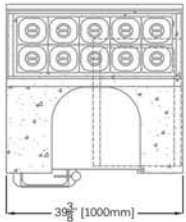

CS1500

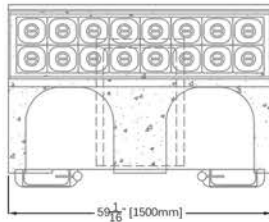

CS2000

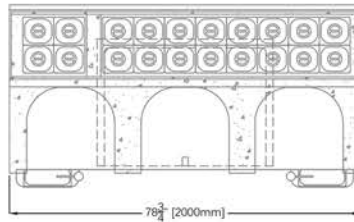

CS2400

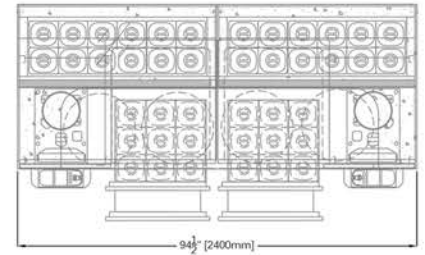

REAR ELEVATIONS (OPERATOR SIDE)

CS1000

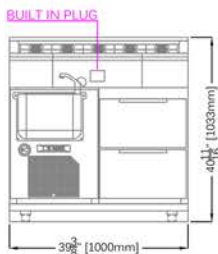

CS1500

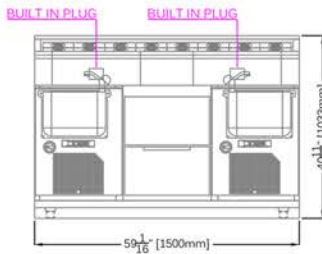

CS2000

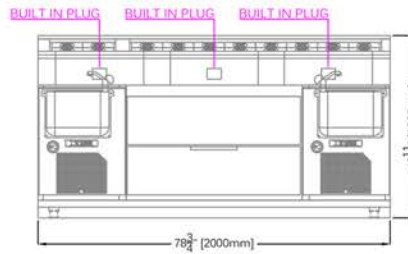

CS2400

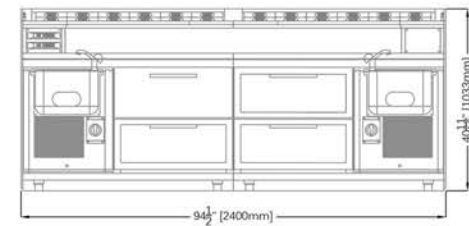

361-367 Beach Road, Burlingame, CA 94010
 Tel: 855.885.2400 | 650.342.2400 | Fax: 650.342.7400
 sales@oscartek.com | www.oscartek.com

