

# CLASSIC

# Neutral Showcase

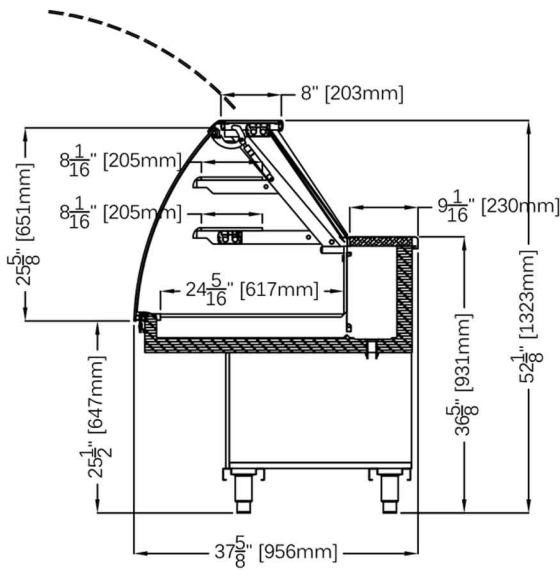

Photo shown is with optional front finish and champagne trim finish. Standard cases are silver trim finish, unfinished front, and stainless steel skin sides



## STANDARD FEATURES

- Stainless steel insulated body with tubular painted galvanized chassis
- Silver trim finish
- Lift up hydraulic front glass
- LED lighting
- Plexiglass sliding doors
- Stainless steel work bench
- Cases ship standard unfinished front and stainless steel skin sides

## OPTIONS

- Marble/Granite work counter
- RAL color finish/wood laminate
- Champagne trim finish
- Matching front cabinetry counters with top glass
- Heated glass shelf with electronic control
- Casters

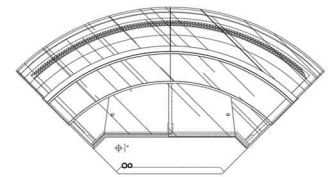

90° Open Corner

| CLASSIC NEUTRAL             |        |                             |                             |                             |                             |                              |                              |
|-----------------------------|--------|-----------------------------|-----------------------------|-----------------------------|-----------------------------|------------------------------|------------------------------|
| TECHNICAL FEATURES          |        | MODELS                      |                             |                             |                             |                              |                              |
|                             |        | CLASSIC CN1000              | CLASSIC CN1500              | CLASSIC CN2000              | CLASSIC CN2500              | CLASSIC CN3000               | CLASSIC CNA90                |
| External Dimensions (L-D-H) | Inches | 39 1/2" - 37 3/4" - 52 1/8" | 59 1/8" - 37 3/4" - 52 1/8" | 78 3/4" - 37 3/4" - 52 1/8" | 98 1/2" - 37 3/4" - 52 1/8" | 118 1/4" - 37 3/4" - 52 1/8" | 80 1/16" - 37 3/4" - 52 1/8" |
|                             | MM     | 1000 - 956 - 1323           | 1500 - 956 - 1323           | 2000 - 956 - 1323           | 2500 - 956 - 1323           | 3000 - 956 - 1323            | 2034 - 956 - 1323            |
| Crated Dimensions (L-D-H)   | Inches | 44" - 42 1/2" - 57"         | 65" - 42 1/4" - 57"         | 84 3/4" - 42 1/4" - 57"     | 102 3/4" - 42 1/4" - 57"    | 122 3/4" - 42 1/4" - 57"     | 86" - 42 1/4" - 57"          |
|                             | MM     | 1100 - 1056 - 1447          | 1600 - 1056 - 1447          | 2100 - 1056 - 1447          | 2600 - 1056 - 1447          | 3100 - 1056 - 1447           | 2184 - 1056 - 1447           |
| Power Supply                | (V)    | 120V                        | 120V                        | 120V                        | 120V                        | 120V                         | 120V                         |
| Amperage                    | (A)    | 3A                          | 4A                          | 4.5A                        | 5A                          | 5.5A                         | 4A                           |
| Operating Temperature       | °F     | Ambient                     | Ambient                     | Ambient                     | Ambient                     | Ambient                      | Ambient                      |
| Net Weights                 | Kg/Lb  | 130Kgs / 286Lbs             | 170Kgs / 374Lbs             | 210Kgs / 462Lbs             | 245Kgs / 539Lbs             | 285Kgs / 627Lbs              | 170Kgs / 374Lbs              |
| Crated Weights              | Kg/Lb  | 150Kgs / 297Lbs             | 190Kgs / 418Lbs             | 230Kgs / 506Lbs             | 271Kgs / 596Lbs             | 310Kgs / 682Lbs              | 190Kgs / 418Lbs              |

\* DIMENSIONS ARE WITHOUT SIDE PANELS

\* Manufacturer reserves the right to change specifications without notice. Not responsible for error and omissions.



361-367 Beach Road, Burlingame, CA 94010  
 Tel: 855.885.2400 | 650.342.2400 | Fax: 650.342.7400  
 sales@oscartek.com | www.oscartek.com

