



STANDARD FEATURES

- Inclined cold display pans
- Cold pans section
- Stainless steel interior and exterior
- Stainless steel kickplate on operator side

OPTIONS

- Glass top/sneeze guard to match Oscartek display case
- Heated pan section
- Stainless steel or transparent pans and lids
- Cold storage
- Stone work top
- Sides and front fascia in HPL or laminate
- Remote
- Casters

FOOD PREP STATION						
MODELS	LENGTHS	DEPTH	HEIGHT	WEIGHTS (LBS)	VOLTAGES	AMPS
FPS1000	39 3/8" (1000mm)	37 1/2" (953mm)	40 11/16" (1033mm)	150	120/1/60	4
FPS1500	60 1/16" (1525mm)	37 1/2" (953mm)	40 11/16" (1033mm)	190	120/1/60	6
FPS2000	78 3/4" (2000mm)	37 1/2" (953mm)	40 11/16" (1033mm)	250	120/1/60	7
FPS2745	108 1/16" (2745mm)	37 1/2" (953mm)	40 11/16" (1033mm)	380	120/1/60	12

* Manufacturer reserves the right to change specifications without notice. Not responsible for error and omissions.

FPS SERIES FRONT COUNTERS

FOOD PREP STATION

STANDARD

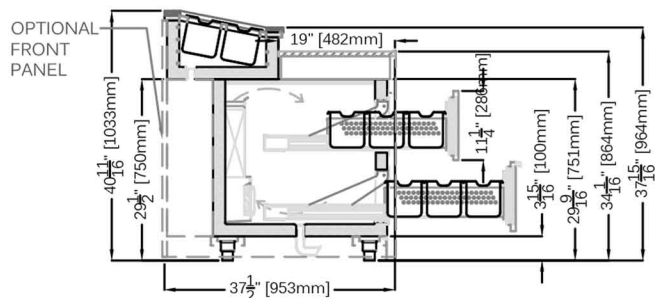

OPTIONAL: SQUARE GLASS GLASS TOP/SNEEZE GUARD

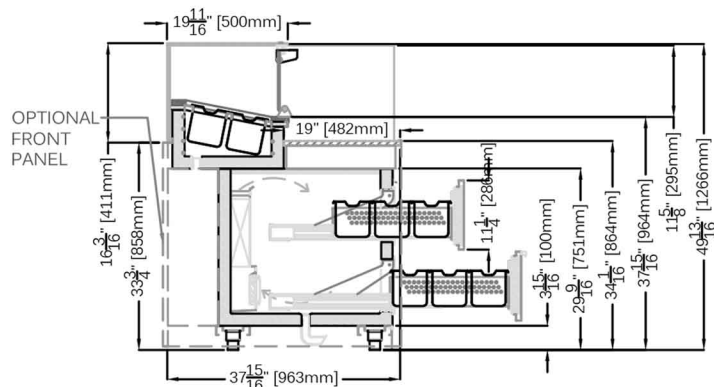

OPTIONAL: CURVE GLASS GLASS TOP/SNEEZE GUARD

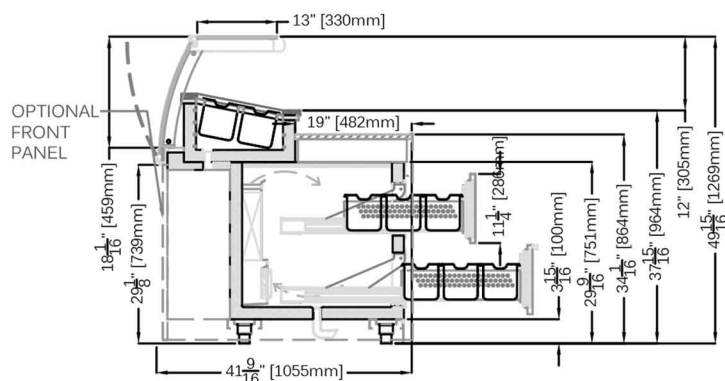

PLAN VIEWS

FPS1000

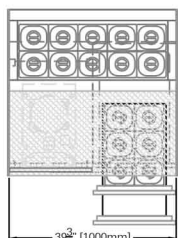

FPS1500

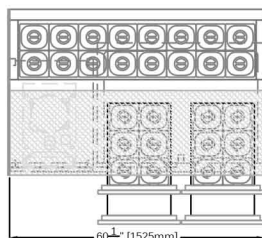

FPS2000

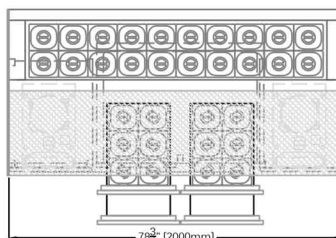

FPS2745

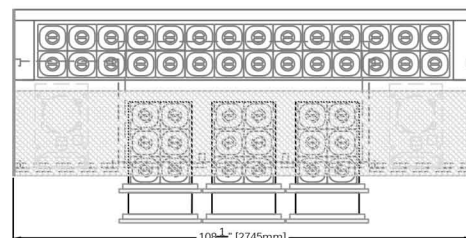

REAR ELEVATIONS (OPERATOR SIDE)

FPS1000

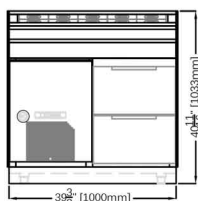

FPS1500

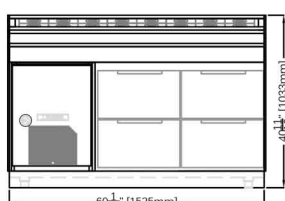

FPS2000

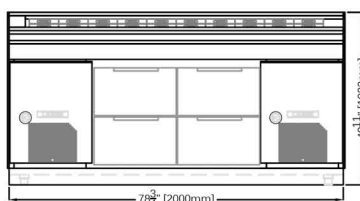

FPS2745

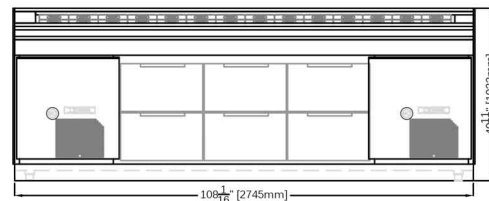

* Manufacturer reserves the right to change specifications without notice. Not responsible for error and omissions.



361-367 Beach Road, Burlingame, CA 94010
Tel: 855.885.2400 | 650.342.2400 | Fax: 650.342.7400
sales@oscartek.com | www.oscartek.com

