



DIAMOND 1-2-3

Neutral Showcase

DIAMOND 1 NEUTRAL MODELS: DIAMOND 1 N1110, DIAMOND 1 N1610, DIAMOND 1 N2106, DIAMOND 1 NA30, DIAMOND 1 NC30

DIAMOND 2 NEUTRAL MODELS: DIAMOND 2 N1110, DIAMOND 2 N1610, DIAMOND 2 N2106, DIAMOND 2 NA30, DIAMOND 2 NC30

DIAMOND 3 NEUTRAL MODELS: DIAMOND 3 N1110, DIAMOND 3 N1610, DIAMOND 3 N2106, DIAMOND 3 NA30, DIAMOND 3 NC30

Diamond 1 Neutral with optional stainless steel front

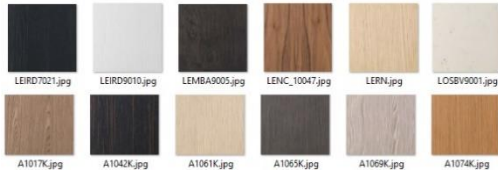

Visit our website for more finishing options and RAL colors
www.oscartek.com

STANDARD FEATURES

- Available in 3 heights: 47”H, 53”H, and 59”H
- Chrome finishing
- Diffused LED lighting 3000°K
- Front glass with safety tilt down opening system
- Pyrolytic anti-fog front and side glass
- Cases ship standard unfinished front and stainless steel skin sides

OPTIONS

- Work top (brushed s/s, corian, granite)
- Stainless steel step shelf
- Epoxy RAL color interior and exterior over stainless steel
- RAL color/custom plastic wood laminate exterior front and sides
- Unfinished panels to accept millwork by others
- Casters

*Oscartek reserves the right to change, modify, discontinue, or change any features, sizes, or capacity on any model without prior notice.

DIAMOND 1-2-3 NEUTRAL

DIAMOND 1 NEUTRAL MODELS: DIAMOND 1 N1110, DIAMOND 1 N1610, DIAMOND 1 N2106, DIAMOND 1 NA30, DIAMOND 1 NC30

DIAMOND 2 NEUTRAL MODELS: DIAMOND 2 N1110, DIAMOND 2 N1610, DIAMOND 2 N2106, DIAMOND 2 NA30, DIAMOND 2 NC30

DIAMOND 3 NEUTRAL MODELS: DIAMOND 3 N1110, DIAMOND 3 N1610, DIAMOND 3 N2106, DIAMOND 3 NA30, DIAMOND 3 NC30

STANDARD: DIAMOND 1-2-3 NEUTRAL PLAN VIEWS

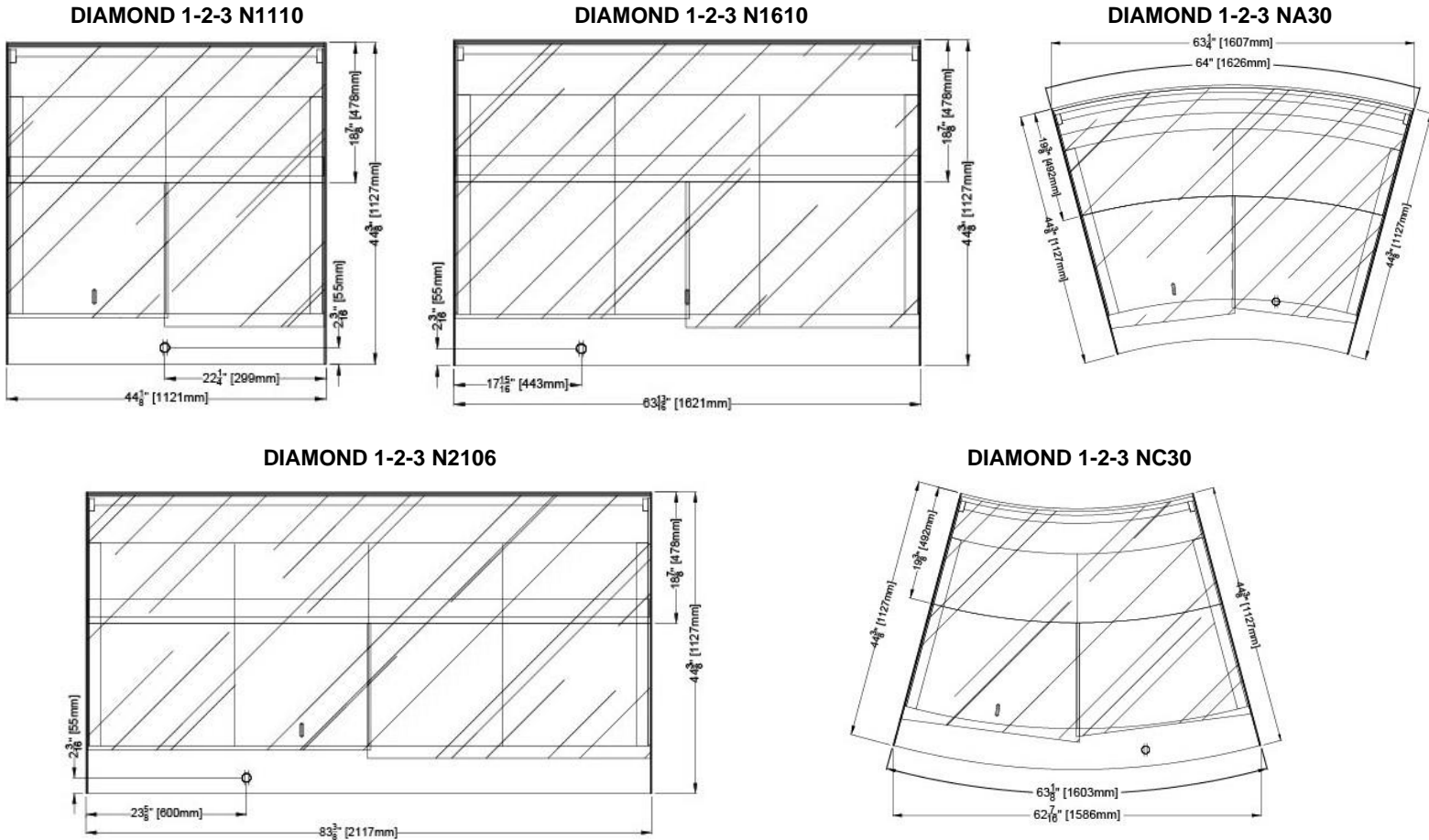

ELECTRICAL LEGEND

 POWER

*Oscartek reserves the right to change, modify, discontinue, or change any features, sizes, or capacity on any model without prior notice.

DIAMOND 1-2-3 NEUTRAL

DIAMOND 1 NEUTRAL MODELS: DIAMOND 1 N1110, DIAMOND 1 N1610, DIAMOND 1 N2106, DIAMOND 1 NA30, DIAMOND 1 NC30

DIAMOND 2 NEUTRAL MODELS: DIAMOND 2 N1110, DIAMOND 2 N1610, DIAMOND 2 N2106, DIAMOND 2 NA30, DIAMOND 2 NC30

DIAMOND 3 NEUTRAL MODELS: DIAMOND 3 N1110, DIAMOND 3 N1610, DIAMOND 3 N2106, DIAMOND 3 NA30, DIAMOND 3 NC30

STANDARD: DIAMOND 1-2-3 NEUTRAL

REAR ELEVATIONS (OPERATOR SIDE)

DIAMOND 1-2-3 NEUTRAL N1110, N1610, N2106

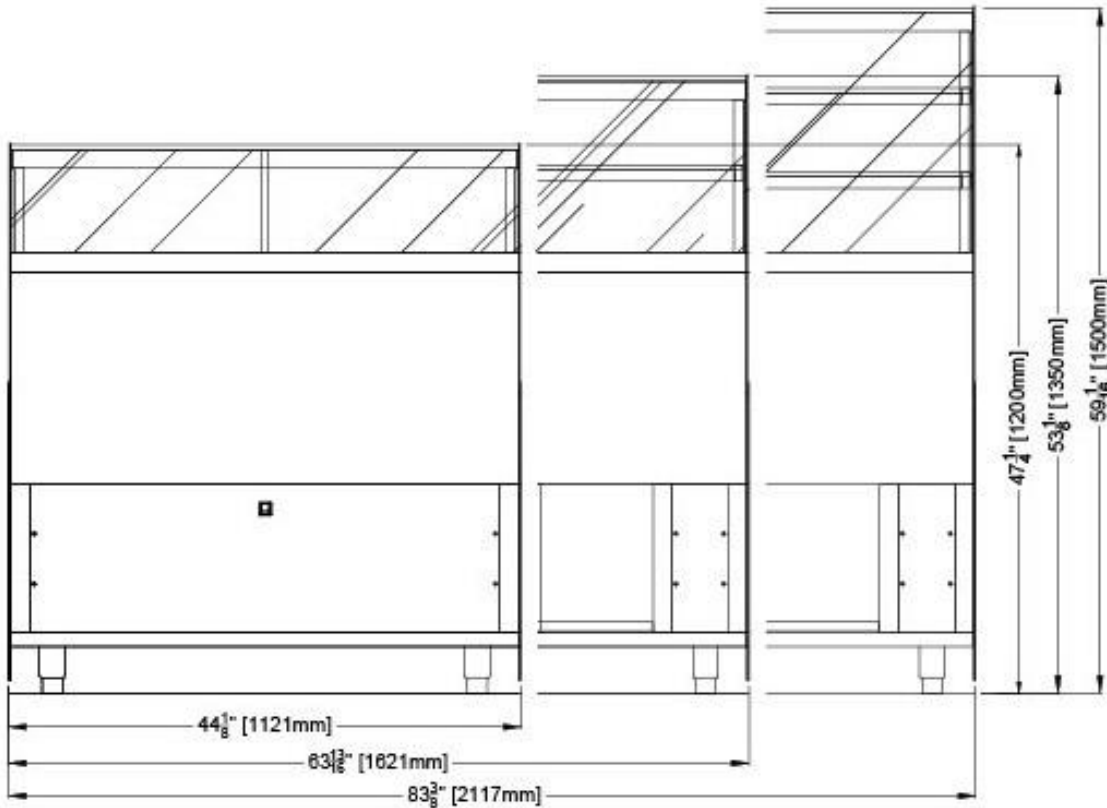

*Oscartek reserves the right to change, modify, discontinue, or change any features, sizes, or capacity on any model without prior notice.

DIAMOND 1-2-3 NEUTRAL

DIAMOND 1 NEUTRAL MODELS: DIAMOND 1 N1110, DIAMOND 1 N1610, DIAMOND 1 N2106, DIAMOND 1 NA30, DIAMOND 1 NC30

DIAMOND 2 NEUTRAL MODELS: DIAMOND 2 N1110, DIAMOND 2 N1610, DIAMOND 2 N2106, DIAMOND 2 NA30, DIAMOND 2 NC30

DIAMOND 3 NEUTRAL MODELS: DIAMOND 3 N1110, DIAMOND 3 N1610, DIAMOND 3 N2106, DIAMOND 3 NA30, DIAMOND 3 NC30

STANDARD: DIAMOND 1-2-3 NEUTRAL SECTION VIEWS

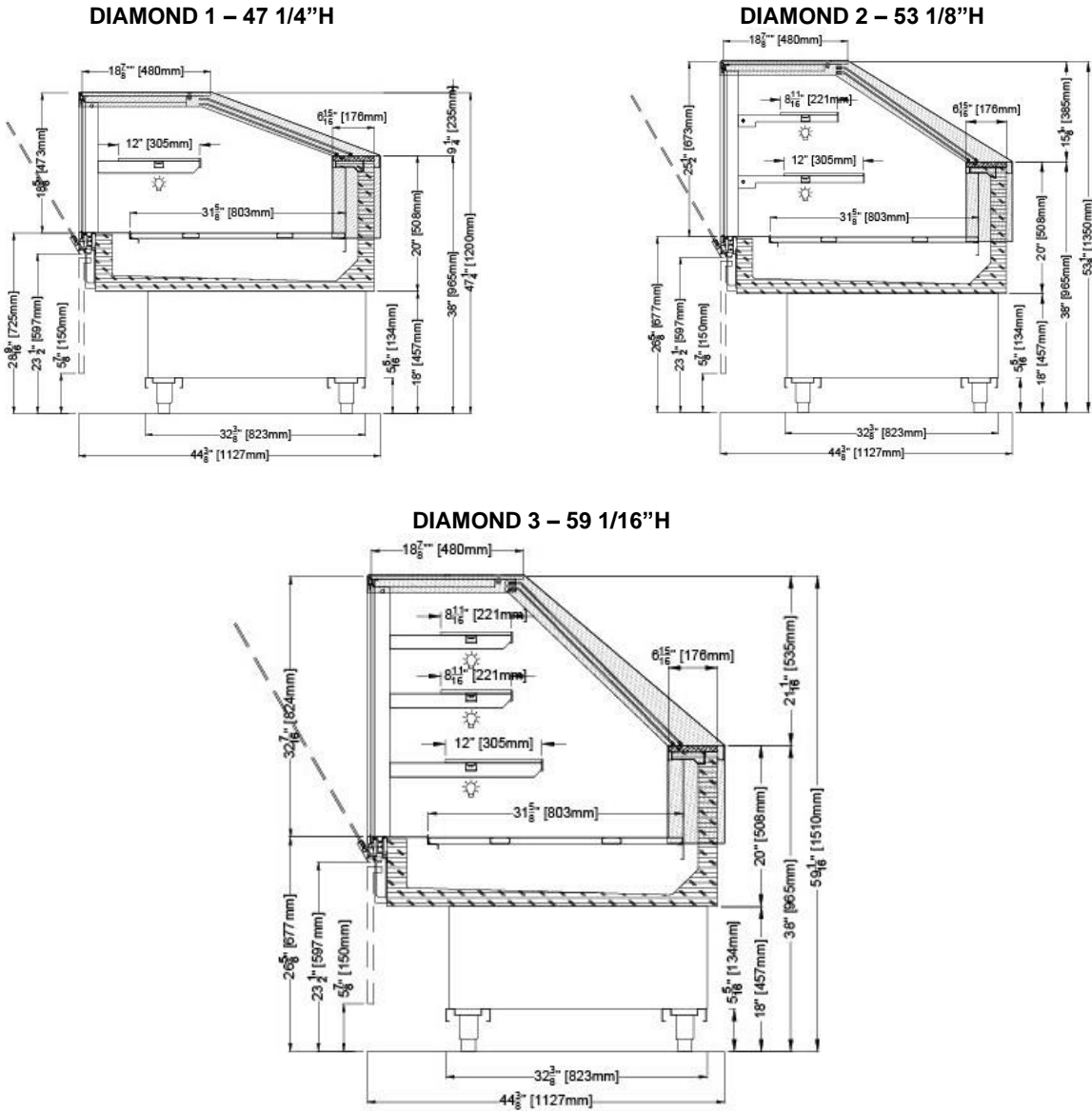

*Oscartek reserves the right to change, modify, discontinue, or change any features, sizes, or capacity on any model without prior notice.



Project Name: _____
 Item #: _____ Quantity: _____

DIAMOND 1-2-3 NEUTRAL

DIAMOND 1 NEUTRAL MODELS: DIAMOND 1 N1110, DIAMOND 1 N1610, DIAMOND 1 N2106, DIAMOND 1 NA30, DIAMOND 1 NC30

DIAMOND 2 NEUTRAL MODELS: DIAMOND 2 N1110, DIAMOND 2 N1610, DIAMOND 2 N2106, DIAMOND 2 NA30, DIAMOND 2 NC30

DIAMOND 3 NEUTRAL MODELS: DIAMOND 3 N1110, DIAMOND 3 N1610, DIAMOND 3 N2106, DIAMOND 3 NA30, DIAMOND 3 NC30

DIAMOND 1 NEUTRAL						
TECHNICAL FEATURES		MODELS				
		DIAMOND 1 N1110 (DMD1NT44)	DIAMOND 1 N1610 (DMD1NT64)	DIAMOND 1 N2106 (DMD1NT83)	DIAMOND 1 NA30 (DMD1NTAP30)	DIAMOND 1 NC30 (DMD1NTCH30)
External Dimensions (L-D-H) Inches-MM	Inches MM	*44 1/8" - 44 3/8" - 47 1/4" *1121 - 1127 - 1200	*63 13/16" - 44 3/8" - 47 1/4" *1621 - 1127 - 1200	*83 3/8" - 44 3/8" - 47 1/4" *2117 - 1127 - 1200	*63 1/4" - 44 3/8" - 47 1/4" *1607 - 1127 - 1200	*62 7/16" - 44 3/8" - 47 1/4" *1586 - 1127 - 1200
Crated Dimensions (L-D-H) Inches-MM	Inches MM	51" - 51" - 53" 1295 - 1295 - 1346	70" - 51" - 53" 1778 - 1295 - 1346	90" - 51" - 53" 2286 - 1295 - 1346	70" - 51" - 53" 1778 - 1295 - 1346	70" - 51" - 53" 1778 - 1295 - 1346
Operating Temperature	°F	Ambient	Ambient	Ambient	Ambient	Ambient
Power Supply	(V/Ph/Hz)	120/1/60	120/1/60	120/1/60	120/1/60	120/1/60
Power Consumption	(W/A)	50/0,5	100/1,0	150/1,5	100/1,0	100/1,0
Net Weights	Lb	440	640	720	600	600
Crated Weights	Lb	530	740	830	700	700

*DIMENSIONS ARE WITH STANDARD POLISHED S/S SKIN SIDES

DIAMOND 2 NEUTRAL						
TECHNICAL FEATURES		MODELS				
		DIAMOND 2 N1110 (DMD2NT44)	DIAMOND 2 N1610 (DMD2NT64)	DIAMOND 2 N2106 (DMD2NT83)	DIAMOND 2 NA30 (DMD2NTAP30)	DIAMOND 2 NC30 (DMD2NTCH30)
External Dimensions (L-D-H) Inches-MM	Inches MM	*44 1/8" - 44 3/8" - 53 1/8" *1121 - 1127 - 1350	*63 13/16" - 44 3/8" - 53 1/8" *1621 - 1127 - 1350	*83 3/8" - 44 3/8" - 53 1/8" *2117 - 1127 - 1350	*63 1/4" - 44 3/8" - 53 1/8" *1607 - 1127 - 1350	*62 7/16" - 44 3/8" - 53 1/8" *1586 - 1127 - 1350
Crated Dimensions (L-D-H) Inches-MM	Inches MM	51" - 51" - 60" 1295 - 1295 - 1524	70" - 51" - 60" 1778 - 1295 - 1524	90" - 51" - 60" 2286 - 1295 - 1524	70" - 51" - 60" 1778 - 1295 - 1524	70" - 51" - 60" 1778 - 1295 - 1524
Operating Temperature	°F	Ambient	Ambient	Ambient	Ambient	Ambient
Power Supply	(V/Ph/Hz)	120/1/60	120/1/60	120/1/60	120/1/60	120/1/60
Power Consumption	(W/A)	70/0,7	150/1,5	200/2,0	150/1,5	150/1,5
Net Weights	Lb	450	650	730	610	610
Crated Weights	Lb	540	750	840	710	710

*DIMENSIONS ARE WITH STANDARD POLISHED S/S SKIN SIDES

DIAMOND 3 NEUTRAL						
TECHNICAL FEATURES		MODELS				
		DIAMOND 3 N1110 (DMD3NT44)	DIAMOND 3 N1610 (DMD3NT64)	DIAMOND 3 N2106 (DMD3NT83)	DIAMOND 3 NA30 (DMD3NTAP30)	DIAMOND 3 NC30 (DMD3NTCH30)
External Dimensions (L-D-H) Inches-MM	Inches MM	*44 1/8" - 44 3/8" - 59 1/16" *1121 - 1127 - 1500	*63 13/16" - 44 3/8" - 59 1/16" *1621 - 1127 - 1500	*83 3/8" - 44 3/8" - 59 1/16" *2117 - 1127 - 1500	*63 1/4" - 44 3/8" - 59 1/16" *1607 - 1127 - 1500	*62 7/16" - 44 3/8" - 59 1/16" *1586 - 1127 - 1500
Crated Dimensions (L-D-H) Inches-MM	Inches MM	51" - 51" - 66" 1295 - 1295 - 1676	70" - 51" - 66" 1778 - 1295 - 1676	90" - 51" - 66" 2286 - 1295 - 1676	70" - 51" - 66" 1778 - 1295 - 1676	70" - 51" - 66" 1778 - 1295 - 1676
Operating Temperature	°F	Ambient	Ambient	Ambient	Ambient	Ambient
Power Supply	(V/Ph/Hz)	120/1/60	120/1/60	120/1/60	120/1/60	120/1/60
Power Consumption	(W/A)	100/1,0	200/2,0	250/2,5	200/2,0	200/2,0
Net Weights	Lb	460	660	740	620	620
Crated Weights	Lb	550	760	850	720	720

*DIMENSIONS ARE WITH STANDARD POLISHED S/S SKIN SIDES

*Oscartek reserves the right to change, modify, discontinue, or change any features, sizes, or capacity on any model without prior notice.

OSCARTEK®
 512 South Airport Blvd., South San Francisco, CA 94080
 Tel: 650.342.2400 | Fax: 650.342.7400
 www.oscartek.com

