

## SECTION A DELI/PASTRY

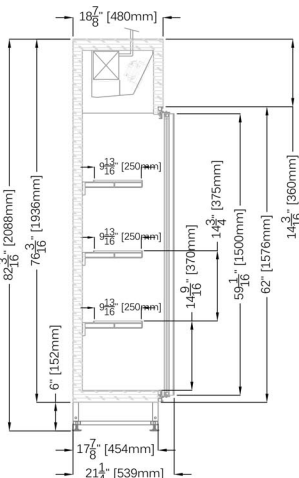

## SECTION B WINE

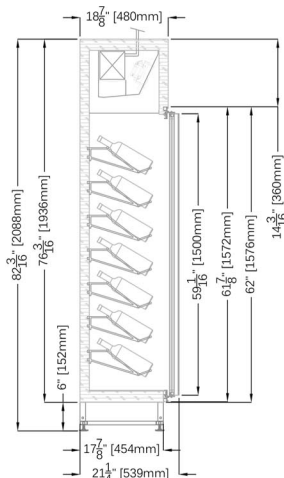

## SECTION C CHARCUTERIE

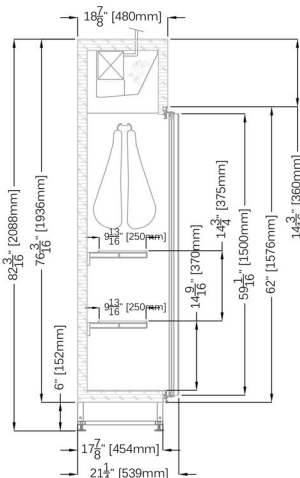

## STANDARD FEATURES

- Steel load bearing structure
- Double pane heated glass front and sides
- LED lighting
- Dixell digital control (individual controls when lined up T1, T2)
- Top evaporator ventilation cooling
- Adjustable feet
- Stainless steel foam in place bottom and top
- Interior vertical shelf support in stainless steel
- Tempered glass shelving/multi-use glass shelving
- Stainless steel wine rack (wine models)
- Case ship standard steel 304A high polish finish

## OPTIONS

- Custom heights and depths available
- Brass steel color finish
- RAL color door frame
- Double sided glass doors
- Acrylic 45° & 90° wine rack
- Door locks
- Top mount condensing unit
- Remote/water cooled condensing unit
- RAL color/laminate/color metal



| GALA (DELI/PASTRY   WINE   CHARCUTERIE) |        |                                |                              |                              |                                 |
|---|--------|--------------------------------|------------------------------|------------------------------|---------------------------------|
| TECHNICAL FEATURES                      |        | MODELS                         |                              |                              |                                 |
|   |        | GALA 830                       | GALA 1552                    | GALA 2274                    | GALA 2996                       |
| External Dimensions (L-D-H)             | Inches | 32 11/16" - 21 1/4" - 76 3/16" | 61 1/8" - 21 1/4" - 76 3/16" | 89 1/2" - 21 1/4" - 76 3/16" | 117 15/16" - 21 1/4" - 76 3/16" |
|   | MM     | 830 - 539 - 1936               | 1552 - 539 - 1936            | 2274 - 539 - 1936            | 2996 - 539 - 1936               |
| Crated Dimensions (L-D-H)               | Inches | 39" - 27" - 83"                | 68" - 27" - 83"              | 96" - 27" - 83"              | 124" - 27" - 83"                |
|   | MM     | 990 - 685 - 2108               | 1727 - 685 - 2108            | 2438 - 685 - 2108            | 3149 - 685 - 2108               |
| BTU's @ +14°F Evap                      |        |                                |                              |                              |                                 |
| Temperature                             | BTU'S  | 3840 BTU'S                     | 6400 BTU'S                   | 8960 BTU'S                   | 10,880 BTU'S                    |
| Power Supply                            | (V/Hz) | 220V/60Hz                      | 220V/60Hz                    | 220V/60Hz                    | 220V/60Hz                       |
| Amperage                                |        |                                |                              |                              |                                 |
| (Light, Fans, heaters)                  | (A)    | 3A                             | 4A                           | 4.5A                         | 5A                              |
| Operating Temperature                   | °F     | 40°F                           | 40°F                         | 40°F                         | 40°F                            |
| Net Weights                             | Kg/Lb  | 100Kgs / 220Lbs                | 200Kgs / 440Lbs              | 300Kgs / 661Lbs              | 400Kgs / 881Lbs                 |
| Crated Weights                          | Kg/Lb  | 145Kgs / 319Lbs                | 220Kgs / 484Lbs              | 255Kgs / 561Lbs              | 255Kgs / 561Lbs                 |

\* REMOTE APPLICATION - CONDENSING UNIT SOLD SEPERATELY

\* FLOOR SINK RECOMMENDED ON THESE MODELS

\*Factory in its effort to upgrade and improve our products, has the right to change, modify, discontinue or change any feature, size or capacity on any model without prior notice.



512 South Airport Blvd., South San Francisco, CA 94080  
 Tel: 855.885.2400 | 650.342.2400 | Fax: 650.342.7400  
 sales@oscartek.com | www.oscartek.com



CUSTOM HEIGHTS & DEPTHS AVAILABLE

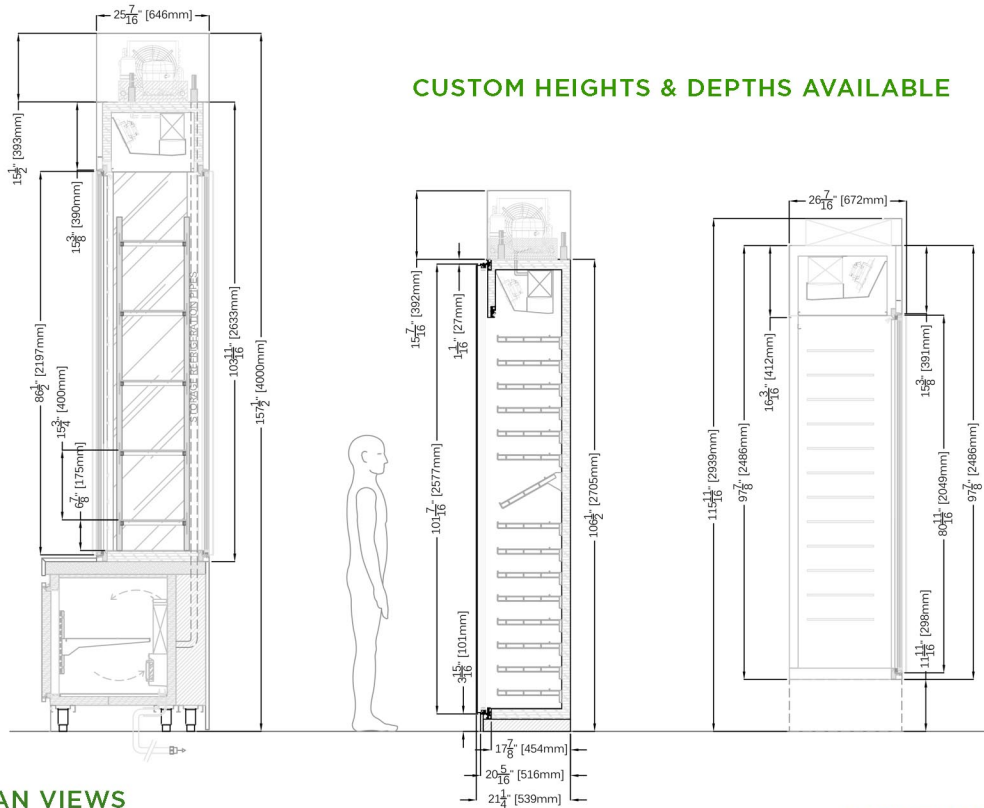

PLAN VIEWS

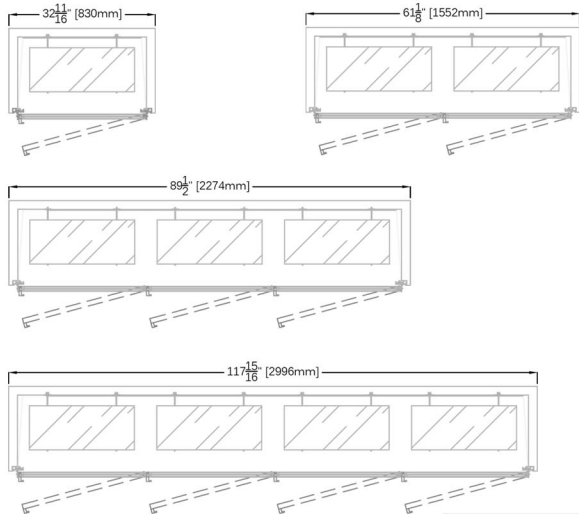

FRONT ELEVATIONS

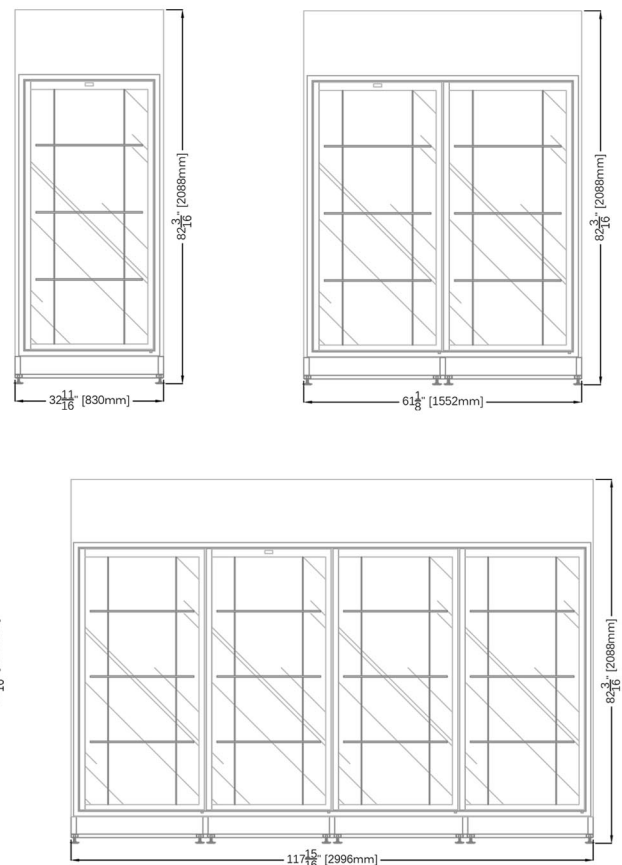

\*Factory in its effort to upgrade and improve our products, has the right to change, modify, discontinue or change any feature, size or capacity on any model without prior notice.