

# ITALIA 1 PRO

## High Humidity Cold Showcase Deli/Pastry | Red Meat | Poultry

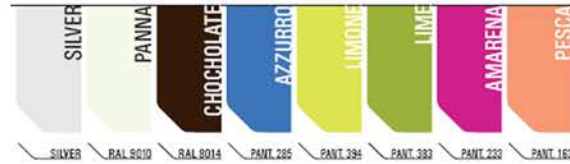

### STANDARD FEATURES

- Maxi display high humidity refrigerated top
- LED lighting system
- Sliding double pane glass drawers
- Double glazed tempered front, sides, and top glass
- Electronic temperature control
- Automatic evaporation system of condensate water
- Perfect visibility on all 4 sides
- Cases ship standard unfinished

### OPTIONS

- Glass frame colors: Black, White, and Gold
- Remote condensing unit
- Decorative front finish
- Matches with Muro H11
- Legs

ITALIA 1 PRO HIGH HUMIDITY COLD SHOWCASE (DELI/PASTRY   RED MEAT   POULTRY)				
TECHNICAL FEATURES		ITALIA 1		
		ITALIA 1 PRO 900	ITALIA 1 PRO 1200	ITALIA 1 PRO 1500
External Dimensions (L-D-H)	Inches	35 9/16" - 32 9/16" - 37 3/8"	47 3/8" - 32 9/16" - 37 3/8"	59 3/16" - 32 9/16" - 37 3/8"
	Inches-MM	904 - 827 - 949	1204 - 827 - 949	1504 - 827 - 949
Crated Dimensions (L-D-H)	Inches	43 3/8" - 39 3/8" - 43"	55 1/8" - 39 3/8" - 43"	66 7/8" - 39 3/8" - 43"
	Inches-MM	1100 - 1000 - 1092	1400 - 1000 - 1092	1700 - 1000 - 1092
Refrigeration	Type	Ventilated	Ventilated	Ventilated
Refrigeration Display Area	Type	Deck / Shelves	Deck / Shelves	Deck / Shelves
Operating Temperature	°C / °F	+4°C / 39.2°F	+4°C / 39.2°F	+4°C / 39.2°F
Compressor	Nr./Type	1 / Hermetic	1 / Hermetic	1 / Hermetic
BTU'S @ +14°F Evap Temperature	BTU's	2100 BTU'S	2950 BTU'S	3500 BTU'S
Electric Supply	(V/Ph/Hz)	230/1/50 (EU)	230/1/50 (EU)	230/1/50 (EU)
		120/1/60 (USA)	120/1/60 (USA)	120/1/60 (USA)
Power Consumption	(W/A)	580W / 6.2A	600W / 7.1A	900W / 8.1A
Defrost	Mode/Type	Automatic	Automatic	Automatic
Climatic Class	N°/°C/°F/H.R.	3/25/77/60%	3/25/77/60%	3/25/77/60%
Refrigerant Gas	Type	R404A	R404A	R404A
Net Weights	Kg/Lb	100Kgs / 220Lbs	130Kgs / 286Lbs	160Kgs / 352Lbs
Crated Weights	Kg/Lb	160Kgs / 352Lbs	210Kgs / 462Lbs	225Kgs / 496Lbs

\* Manufacturer reserves the right to change specifications without notice. Not responsible for error and omissions.



361-367 Beach Road, Burlingame, CA 94010  
 Tel: 855.885.2400 | 650.342.2400 | Fax: 650.342.7400  
 sales@oscartek.com | www.oscartek.com



# ITALIA 1 PRO

## High Humidity Cold Showcase Deli/Pastry | Red Meat | Poultry

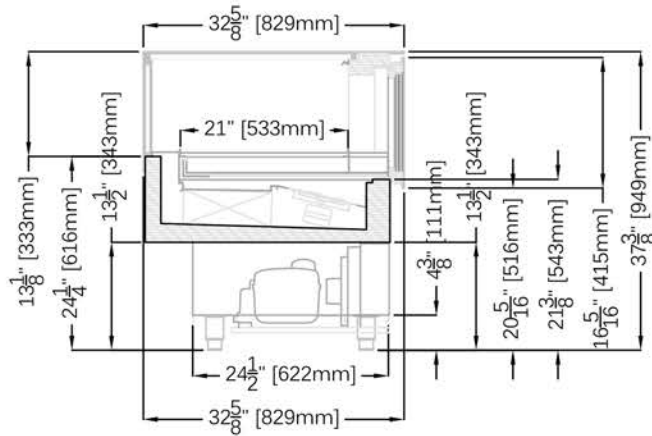

### PLAN VIEW

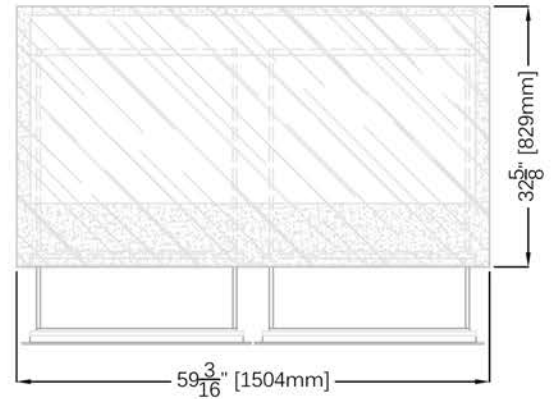
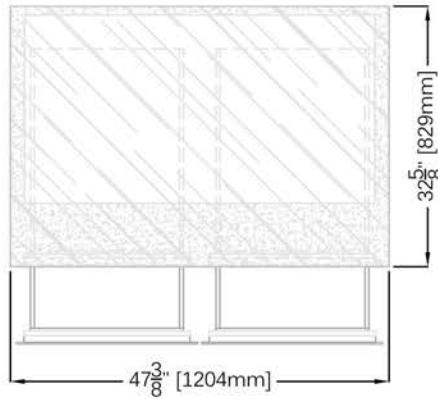
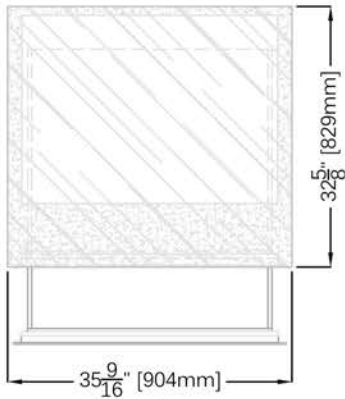

### REAR ELEVATION (OPERATOR SIDE)

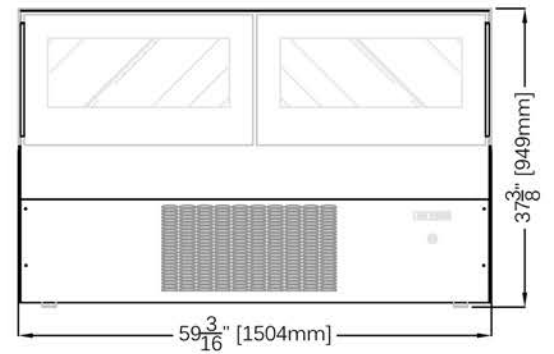
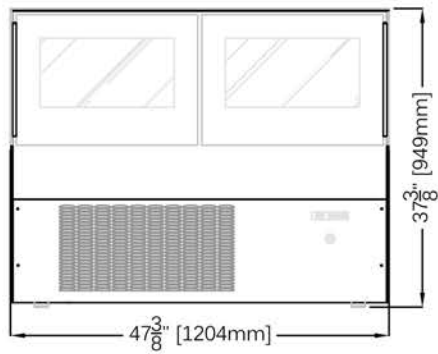
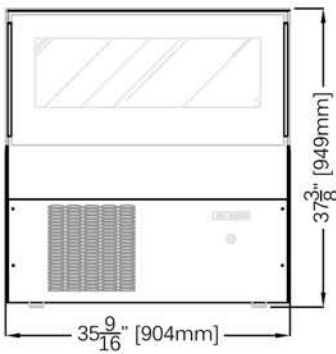

\* Manufacturer reserves the right to change specifications without notice. Not responsible for error and omissions.



361-367 Beach Road, Burlingame, CA 94010  
 Tel: 855.885.2400 | 650.342.2400 | Fax: 650.342.7400  
 sales@oscartek.com | www.oscartek.com

