

METRO II

Deli/Pastry Showcase

OPTIONAL WORK SHELF

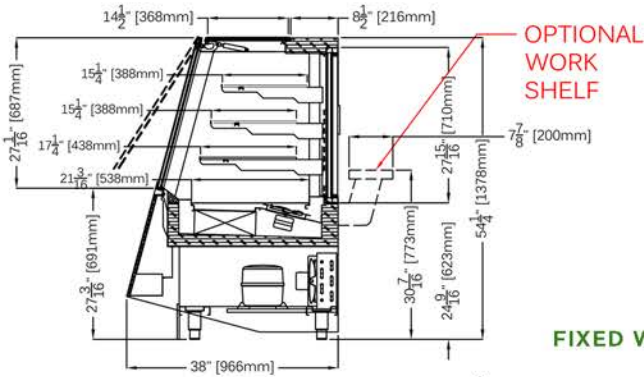

FIXED WORK SHELF

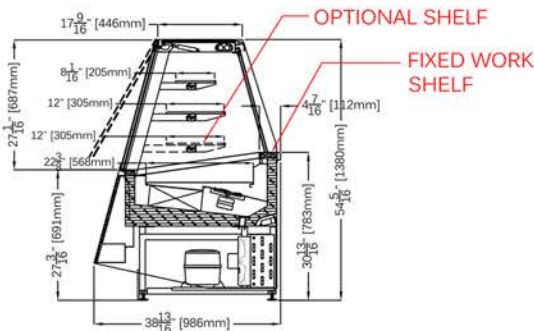

STANDARD FEATURES

- Matches with Metro & Metro II line
- LED lighting system
- Lift up double pane hydraulic front glass
- Double pane sliding glass back doors
- Extra clear glass upper structure
- Stainless steel lower interior foam tub
- Galvanized chassis structure
- All tempered glass
- Cases ship standard unfinished

OPTIONS

- Remote condensing unit
- Additional shelf
- RAL color/laminate front and side panels
- Casters

METRO II DELI/PASTRY					
TECHNICAL FEATURES		MODELS			
		METRO II DP1150	METRO II DP1650	METRO II DP2150	METRO II DPA45
External Dimensions (L-D-H)	Inches	45 1/4" - 38 13/16" - 54 5/16"	64 15/16" - 38 13/16" - 54 5/16"	84 5/8" - 38 13/16" - 54 5/16"	64 15/16" - 38 13/16" - 54 5/16"
	Inches-MM	1150 - 986 - 1380	1650 - 986 - 1380	2150 - 986 - 1380	1650 - 986 - 1380
Crated Dimensions (L-D-H)	Inches	54 1/3" - 45" - 61"	71" - 45" - 61"	93" - 45" - 61"	71" - 45" - 61"
	Inches-MM	1380 - 1143 - 1549	1803 - 1143 - 1549	2362 - 1143 - 1549	1803 - 1143 - 1549
Refrigeration	Type	Fan Ventilated	Fan Ventilated	Fan Ventilated	Fan Ventilated
Refrigeration Display Area	Type	Deck / Shelves	Deck / Shelves	Deck / Shelves	Deck / Shelves
Operating Temperature	°C / °F	+4°C / 39.2°F	+4°C / 39.2°F	+4°C / 39.2°F	+4°C / 39.2°F
Compressor	Nr./Type	1 / Hermetic	1 / Hermetic	2 / Hermetic	1 / Hermetic
BTU's @+14°F Evap					
Temperature	BTU'S	2560 BTU'S	3200 BTU'S	3850 BTU'S	3200 BTU'S
		230/1/50 (EU)	230/1/50 (EU)	230/1/50 (EU)	230/1/50 (EU)
Electric Supply	(V/Ph/Hz)	120/1/60	120/1/60	120/1/60	120/1/60
Power Consumption	(W/A)	1000W / 5.8A	1200W / 8.5A	1600W / 9A	1200W / 8.5A
Defrost	Mode/Type	Automatic	Automatic	Automatic	Automatic
Climatic Class	N°/°C/F°/H.R.	4+/35/95/70%	4+/35/95/70%	4+/35/95/70%	4+/35/95/70%
Refrigerant Gas	Type	R404A	R404A	R404A	R404A
Net Weights	Kg/Lb	266Kgs / 586Lbs	350Kgs / 771Lbs	430Kgs / 992Lbs	350Kgs / 771Lbs
Crated Weights	Kg/Lb	391Kgs / 862Lbs	525Kgs / 1157Lbs	650Kgs / 1433Lbs	525Kgs / 1157Lbs

* Dimensions are without side panels



361-367 Beach Road, Burlingame, CA 94010
 Tel: 855.885.2400 | 650.342.2400 | Fax: 650.342.7400
 sales@oscartek.com | www.oscartek.com

