

# MURO GALA

# Chocolate Showcase

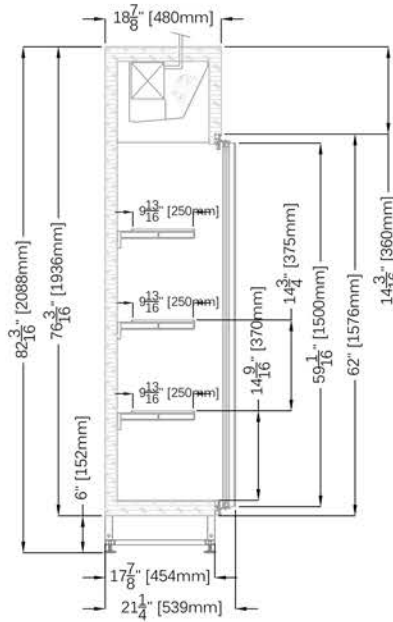

## STANDARD FEATURES

- Steel load bearing structure
- Double pane heated glass front and sides
- LED lighting
- Dixell digital control (individual controls when lined up T1, T2)
- Humidity control
- Top evaporator ventilation cooling
- Adjustable feet
- Stainless steel foam in place bottom and top
- Interior vertical shelf support in stainless steel
- Tempered glass shelving/multi-use glass shelving
- Case ship standard steel 304A high polish finish

## OPTIONS

- Custom heights and depths available
- Brass, steel color finish
- RAL color door frame
- Double sided glass doors
- Acrylic 45° & 90° wine rack
- Top mount condensing unit
- Remote/water cooled condensing unit
- RAL color/laminate/color metal

MURO GALA CHOCOLATE					
TECHNICAL FEATURES		MODELS			
		MURO GALA C830	MURO GALA C1552	MURO GALA C2274	MURO GALA C2996
External Dimensions (L-D-H)	Inches	32 11/16" - 21 1/4" - 76 3/16"	61 1/8" - 21 1/4" - 76 3/16"	89 1/2" - 21 1/4" - 76 3/16"	117 15/16" - 21 1/4" - 76 3/16"
	MM	830 - 539 - 1936	1552 - 539 - 1936	2274 - 539 - 1936	2996 - 539 - 1936
Crated Dimensions (L-D-H)	Inches	39" - 27" - 83"	68" - 27" - 83"	96" - 27" - 83"	124" - 27" - 83"
	MM	990 - 685 - 2108	1727 - 685 - 2108	2438 - 685 - 2108	3149 - 685 - 2108
Humidity Control	Type	35-70%	35-70%	35-70%	35-70%
BTU's @ +35°F Evap	BTU'S	5120 BTU'S	9600 BTU'S	11,520 BTU'S	12,800 BTU'S
Power Supply	(V/Hz)	220V/60Hz	220V/60Hz	220V/60Hz	220V/60Hz
Amperage (Light, Fans, Heaters)	(A)	3A	4A	4.5A	5A
Operating Temperature	°F	55°F	55°F	55°F	55°F
Net Weights	Kg/Lb	100Kgs / 220Lbs	200Kgs / 440Lbs	300Kgs / 661Lbs	400Kgs / 881Lbs
Crated Weights	Kg/Lb	145Kgs / 319Lbs	220Kgs / 484Lbs	255Kgs / 561Lbs	255Kgs / 561Lbs

\* Remote Application - condensing unit sold separately

\* Floor sink recommended on these models

\* 85°F Ambient and 55% Relative humidity

\* Manufacturer reserves the right to change specifications without notice. Not responsible for error and omissions.



361-367 Beach Road, Burlingame, CA 94010  
 Tel: 855.885.2400 | 650.342.2400 | Fax: 650.342.7400  
 sales@oscartek.com | www.oscartek.com



# MURO GALA

# Chocolate Showcase

CUSTOM HEIGHTS & DEPTHS AVAILABLE

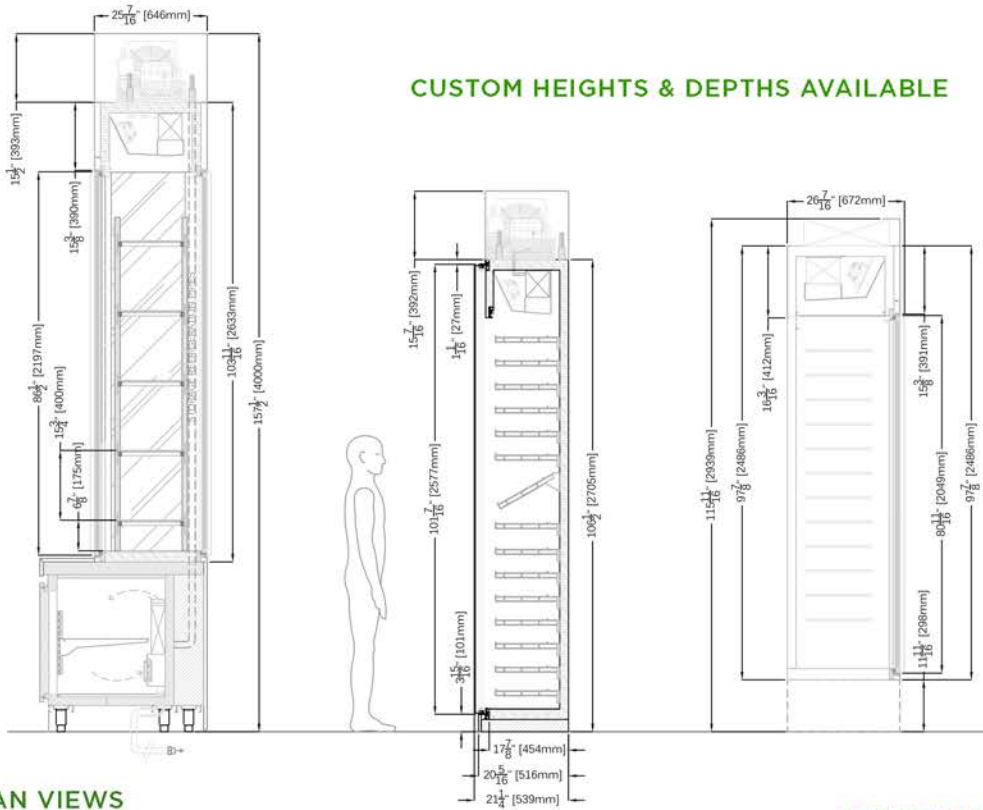

## PLAN VIEWS

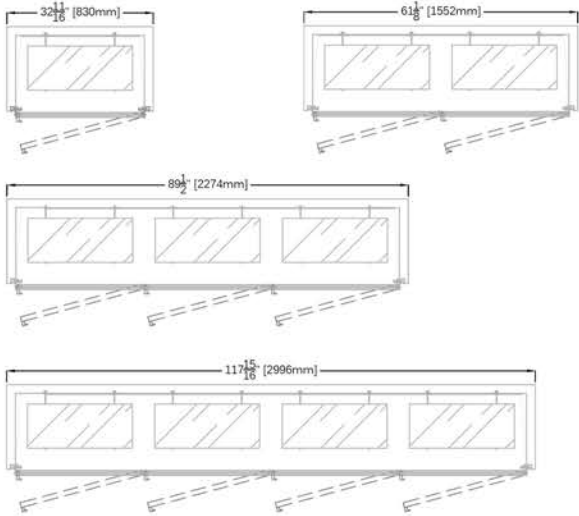

## FRONT ELEVATIONS

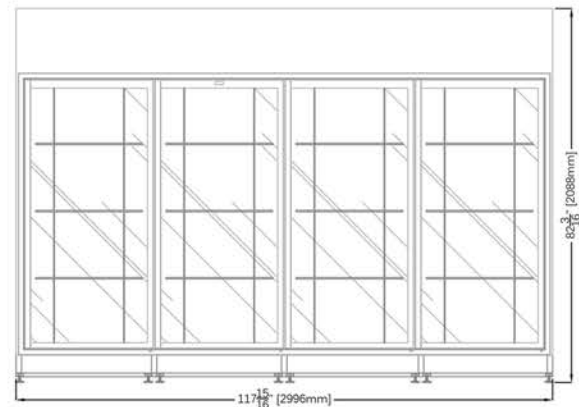
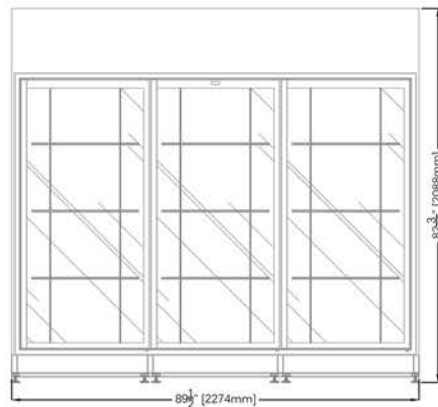
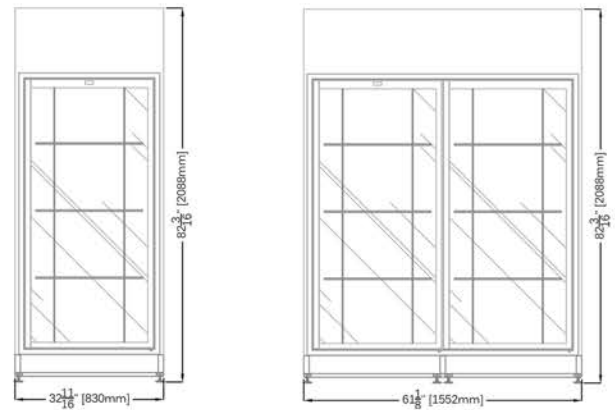

\* Manufacturer reserves the right to change specifications without notice. Not responsible for error and omissions.



361-367 Beach Road, Burlingame, CA 94010  
 Tel: 855.885.2400 | 650.342.2400 | Fax: 650.342.7400  
 sales@oscartek.com | www.oscartek.com

