

# ROW SERIES BACK COUNTERS

# REFRIGERATED OPEN WALL DISPLAY

## STANDARD FEATURES

- Free standing or wall mounted stainless steel cooler
- Finish in high polish stainless steel interior and exterior
- Rounded corners inside the model
- Heat insulation with ecological polyurethane foam
- Height adjustable intermediate glass shelf
- Removable stainless steel bottom grids
- Internal LED lighting system
- Ventilated refrigeration with central evaporator
- Thermostatic valve
- Digital control panel supplied
- Sustaining bars with easy mounting system

## OPTION

- Epoxy paint over stainless steel
- Water cooled condensing unit
- Open wall display without wall panel



## REFRIGERATED OPEN WALL DISPLAY SPECIFICATIONS

MODELS	LENGTHS	DEPTH	HEIGHT	WEIGHTS (LBS)	REMOTE BTU'S +14°F EVAP	* VOLTAGES	AMPS
ROW1000	39 3/8" (1000mm)	27 3/16" (690mm)	92 1/2" (2350mm)	143	2730	120	5
ROW1500	59 1/16" (1500mm)	27 3/16" (690mm)	92 1/2" (2350mm)	185	4100	120	6
ROW2000	78 3/4" (2000mm)	27 3/16" (690mm)	92 1/2" (2350mm)	220	5460	120	7

\* REMOTE CONDENSING UNIT NOT SUPPLIED

\* Manufacturer reserves the right to change specifications without notice. Not responsible for error and omissions.



361-367 Beach Road, Burlingame, CA 94010  
Tel: 855.885.2400 | 650.342.2400 | Fax: 650.342.7400  
sales@oscartek.com | www.oscartek.com



# ROW SERIES BACK COUNTERS

# REFRIGERATED OPEN WALL DISPLAY

**STANDARD:  
OPEN WALL DISPLAY  
WITH WALL PANEL**

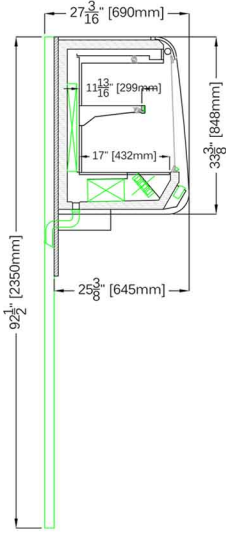

**OPTIONAL:  
OPEN WALL DISPLAY  
WITHOUT WALL PANEL**

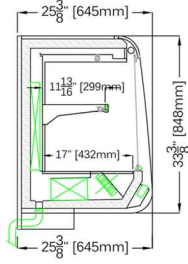

**ROW1000**

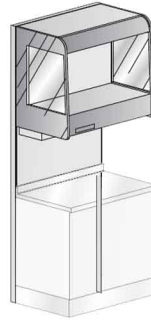

**ROW1500**

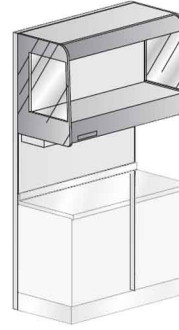

**ROW2000**

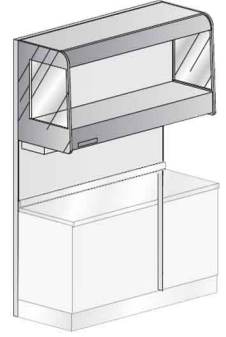

**OPTIONAL: OPEN WALL DISPLAY  
WITHOUT WALL PANEL**

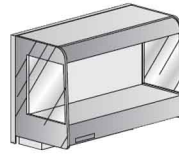

## PLAN VIEWS

**ROW1000**

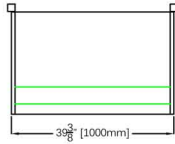

**ROW1500**

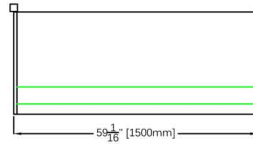

**ROW2000**

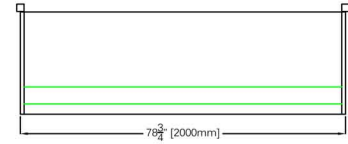

## FRONT ELEVATIONS (CUSTOMER SIDE)

**ROW1000**

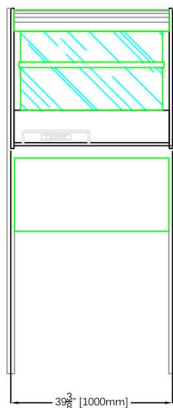

**ROW1500**

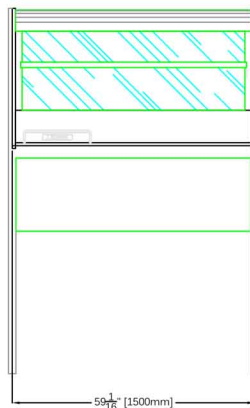

**ROW2000**

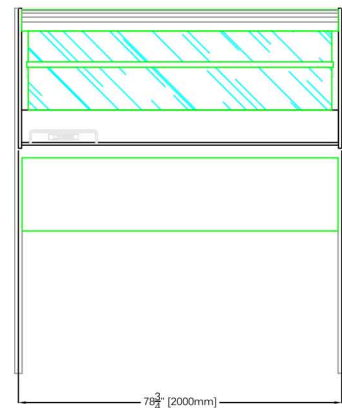

\* Manufacturer reserves the right to change specifications without notice. Not responsible for error and omissions.



361-367 Beach Road, Burlingame, CA 94010  
Tel: 855.885.2400 | 650.342.2400 | Fax: 650.342.7400  
sales@oscartek.com | www.oscartek.com

