



STANDARD FEATURES

- Free standing or wall mounted stainless steel model (white epoxy interior finish)
- 38°F operating temperature
- Rounded corners inside the model
- Heat insulation with ecological polyurethane foam
- Height adjustable intermediate glass shelf
- Removable stainless steel bottom grids
- Double glazed doors "glass" version
- Internal LED lighting system
- Ventilated refrigeration with central evaporator
- Thermostatic valve
- Digital control panel supplied
- Sustaining bars with easy mounting system

REFRIGERATED WALL SHELVING DISPLAY

MODELS	LENGTHS	DEPTHS	HEIGHTS	# OF DOORS	WEIGHTS (LBS)	REMOTE BTU'S +14°F EVAP TEMP	* VOLTAGES	AMPS
VRW1000 A	39 3/8" (1000mm)	19 7/8" (505mm)	88 3/4" (2255mm)	2	320	1100	120	3
VRW1500 A	59 1/16" (1500mm)	19 7/8" (505mm)	88 3/4" (2255mm)	3	420	1470	120	4
VRW1000 B	39 3/8" (1000mm)	17 11/16" (449mm)	32 1/4" (819mm)	2	295	1100	120	3
VRW1500 B	59 1/16" (1500mm)	17 11/16" (449mm)	32 1/4" (819mm)	3	405	1470	120	4

A = 19 7/8"D, 88 3/4"H - INCLUDING WALL PANEL

B = 17 11/16"D, 32 1/4"H - FREE STANDING/WITHOUT WALL PANEL

*** REMOTE CONDENSING UNIT NOT SUPPLIED**

* Manufacturer reserves the right to change specifications without notice. Not responsible for error and omissions.



361-367 Beach Road, Burlingame, CA 94010
 Tel: 855.885.2400 | 650.342.2400 | Fax: 650.342.7400
 sales@oscartek.com | www.oscartek.com



RWS SERIES BACK WALLS

REFRIGERATED WALL SHELVING DISPLAY

**A - 19 7/8" D (505MM)
88 3/4" H (2255MM)
WITH WALL PANEL**

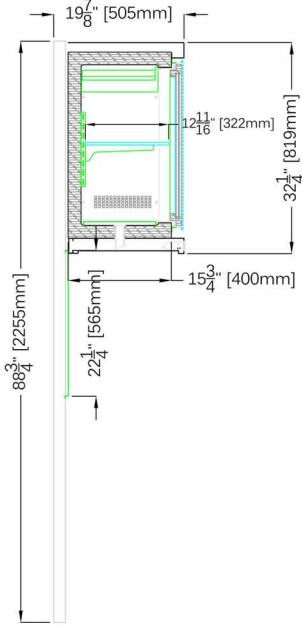

**B - 17 11/16" D (449MM)
32 1/4" H (819MM)
WITHOUT WALL PANEL**

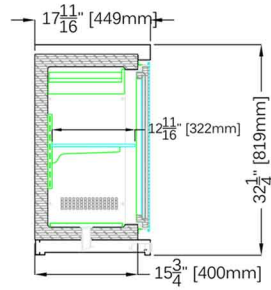

WITH WALL PANEL



VRW1000

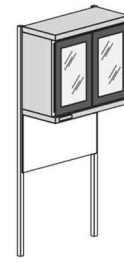

VRW1500

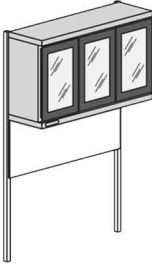

WITHOUT WALL PANEL



PLAN VIEWS

VRW1000

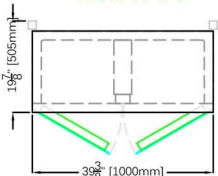

VRW1500

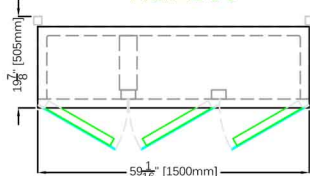

VRW1000

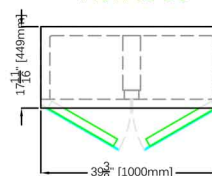

VRW1500

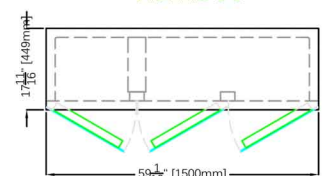

A - 19 7/8" D 88 3/4" H WITH WALL PANEL

B - 17 11/16" D, 32 1/4" H WITHOUT WALL PANEL

REAR ELEVATIONS (OPERATOR SIDE)

VRW1000

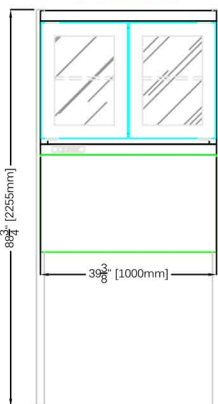

VRW1500

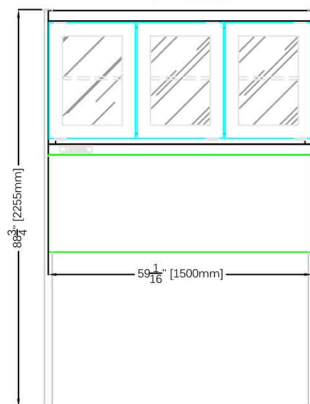

VRW1000

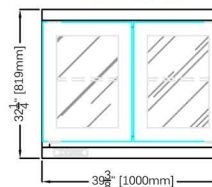

VRW1500

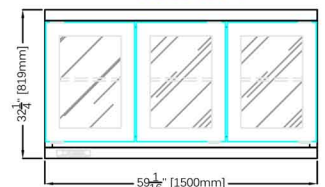

B - 17 11/16" D, 32 1/4" H WITHOUT WALL PANEL

A - 19 7/8" D, 88 3/4" H WITH WALL PANEL

* Manufacturer reserves the right to change specifications without notice. Not responsible for error and omissions.



361-367 Beach Road, Burlingame, CA 94010
Tel: 855.885.2400 | 650.342.2400 | Fax: 650.342.7400
sales@oscartek.com | www.oscartek.com

